

BAZ

Lamelhouder wordt uitsluitend  
toegepast met een dragerprofiel  
Overzicht dragers op tek. ST-Dragers

Aluminium extrusie kwaliteit  
EN AW 6063 T66

LAMEL TYPE: ST-095-01

Steek	95	mm
Diepte	77.2	mm
Hoogte	102.1	mm
K-factor	11.41	
Max. horizontale overspanning tussen twee dragers	1300	mm
bij winddruk Q=800 Pa		
Visuele vrije doorlaat	86	%
Fysische vrije doorlaat	55.5	%

**STORAX**

Storax BV  
Wattstraat 1  
3335 LV Zwijndrecht  
Nederland

Tel. : +31 (0)78 303 09 00  
Fax : +31 (0)78 610 04 95  
E-mail: storax@storax.nl  
Website: www.storax.nl

Productgroep: Lamellenwand

Onderdeel :Lamel type ST-095-01

Materiaal :Aluminium

Schaal: 1:1

Datum: 01-06-2016

Blad:

**ST-095-01**

ST-095-01

ST-095-31

ST-095-33

DSN

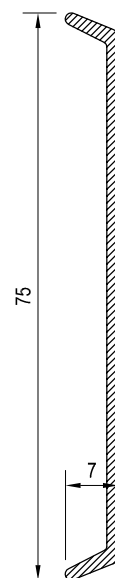

passend in ST-095-01



ST-095-31 dichte plaat

schaal 1:1

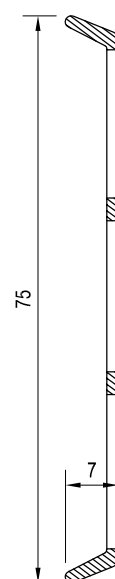

passend in ST-095-01

K-factor = 15.38 Fysische vrije doorlaat 42 %

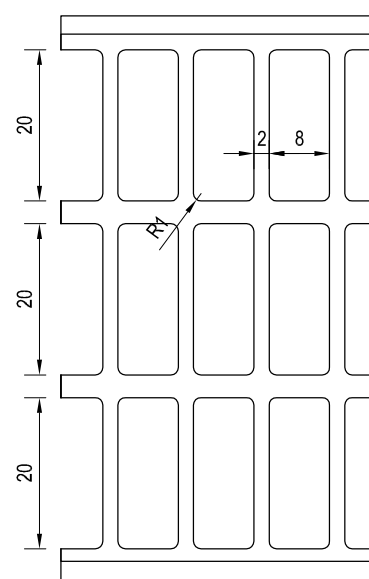

ST-095-33 gaas

**STORAX**

Storax BV  
Wattstraat 1  
3335 LV Zwijndrecht  
Nederland

Tel. : +31 (0)78 303 09 00  
Fax : +31 (0)78 610 04 95  
E-mail: storax@storax.nl  
Website: www.storax.nl

Productgroep: Lamellenwand

Onderdeel : Gaas type ST-095-31 en 33

Materiaal : Kunststof

Schaal: 1:1

Datum: 01-06-2016

Blad:

**ST-095-31-33**

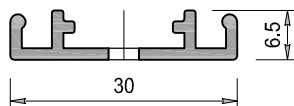

DRAAGPROFIEL TYPE: ST-0065	
Profiel diepte	6.5 mm
Profiel breedte	30 mm
Bevestiging	
h.o.h. maximaal	500 mm

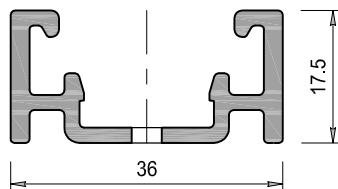

DRAAGPROFIEL TYPE: ST-0195	
Profiel diepte	17.5 mm
Profiel breedte	36 mm
Maximale verticale overspanning bij winddruk Q=800 Pa, ca.	600 mm

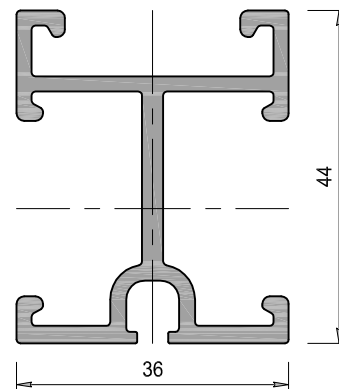

DRAAGPROFIEL TYPE: ST-0440	
Profiel diepte	44 mm
Profiel breedte	36 mm
Maximale verticale overspanning bij winddruk Q=800 Pa, ca.	1500 mm

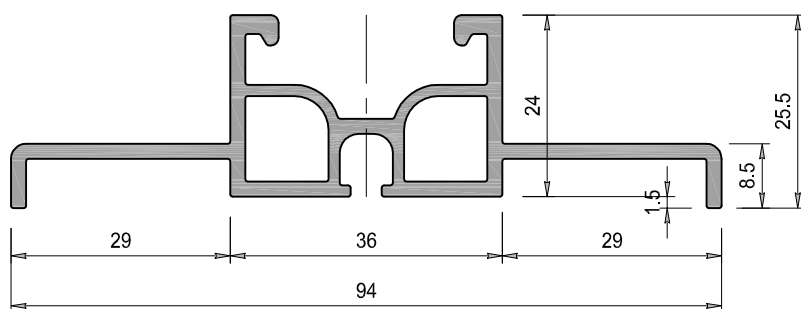

DRAAGPROFIEL TYPE: ST-0240	
Profiel diepte	25.5 mm
Profiel breedte	94 mm
Maximale verticale overspanning bij winddruk Q=800 Pa, ca.	1120 mm

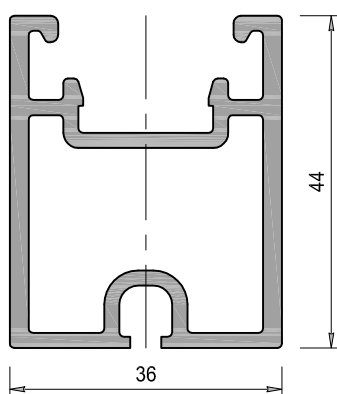

DRAAGPROFIEL TYPE: ST-0460	
Profiel diepte	44 mm
Profiel breedte	36 mm
Maximale verticale overspanning bij winddruk Q=800 Pa, ca.	1500 mm

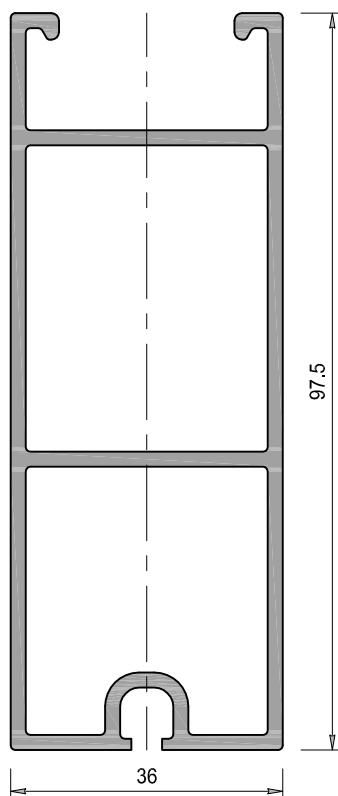

DRAAGPROFIEL TYPE: ST-0995	
Profiel diepte	97.5 mm
Profiel breedte	36 mm
Maximale verticale overspanning bij winddruk Q=800 Pa, ca.	2800 mm

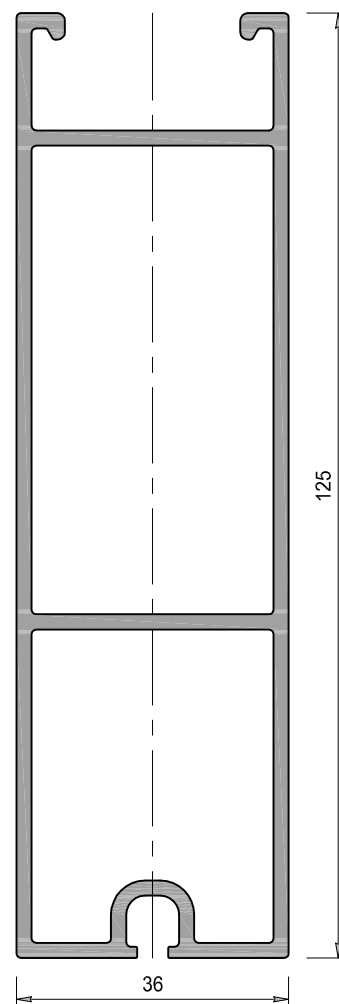

DRAAGPROFIEL TYPE: ST-1250	
Profiel diepte	125 mm
Profiel breedte	36 mm
Maximale verticale overspanning bij winddruk Q=800 Pa, ca.	3600 mm

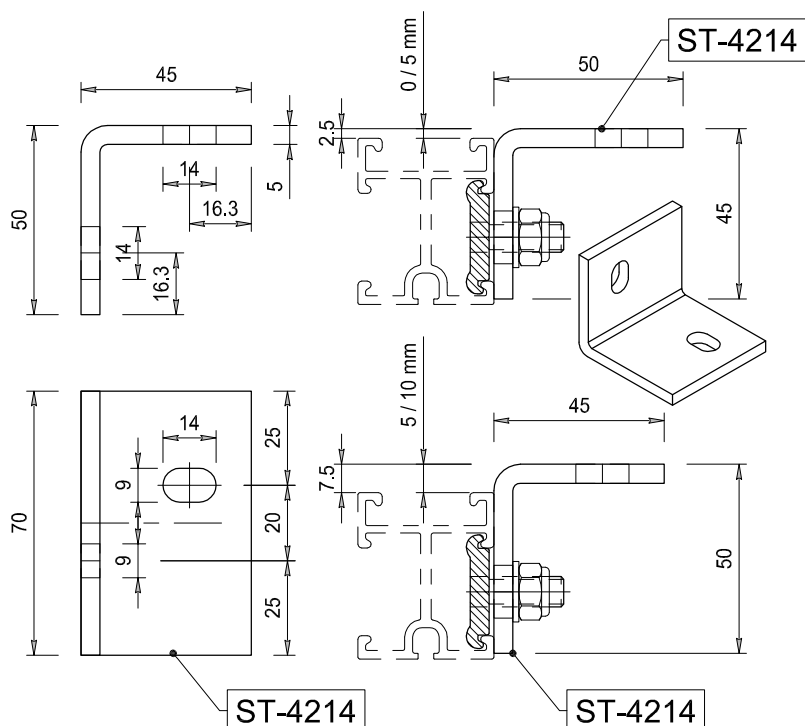
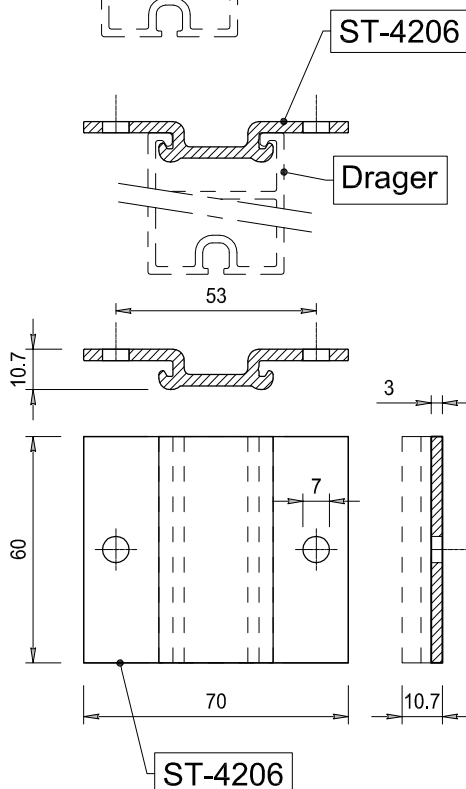
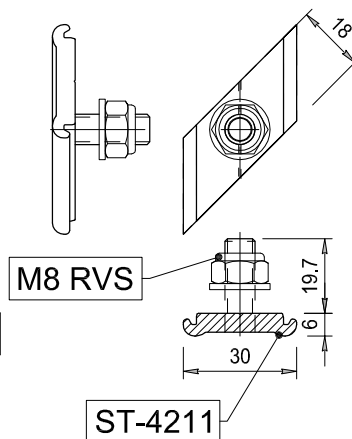
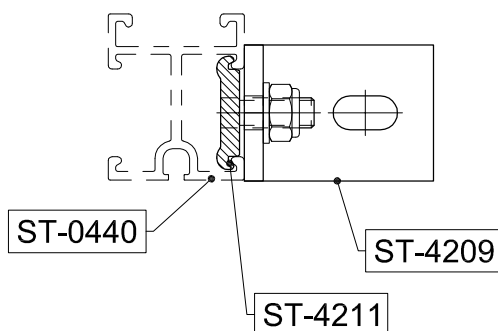
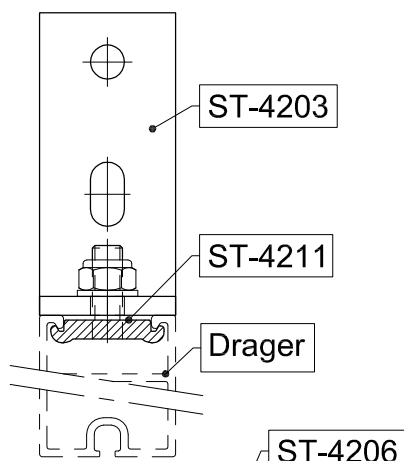
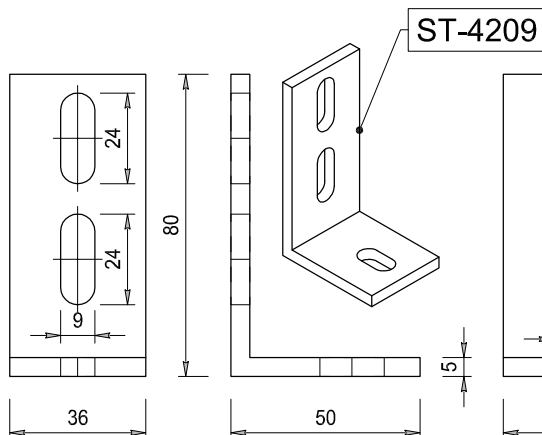
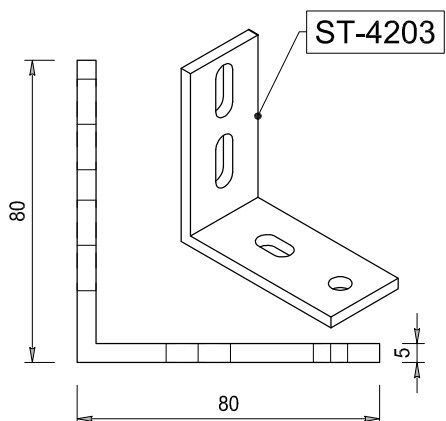
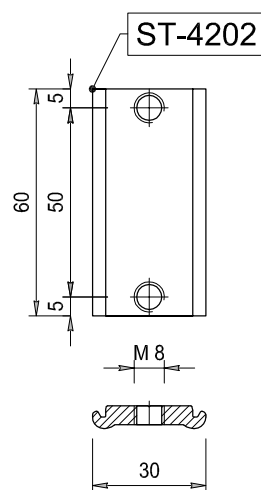
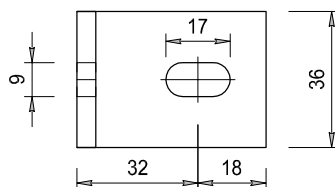
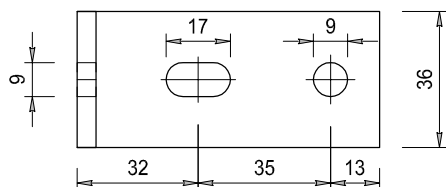

**STORAX**

Storax BV  
Wattstraat 1  
3335 LV Zwijndrecht  
Nederland

Tel. : +31 (0)78 303 09 00  
Fax : +31 (0)78 610 04 95  
E-mail: storax@storax.nl  
Website: www.storax.nl

Productgroep: Lamellenwand

Onderdeel : Overzicht Bevestigings onderdelen

Materiaal : Aluminium / RVS

Schaal: 1:2

Datum: 01-06-2016

Blad:

**ST-Bevestiging**

ST-095-01  
ST-0065

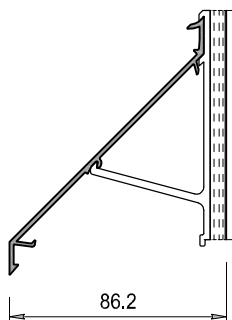
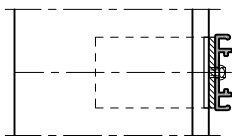

ST-095-01  
ST-0195

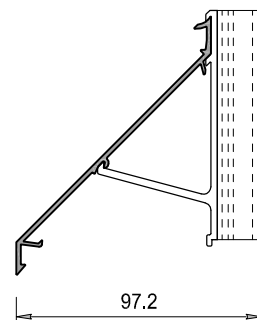
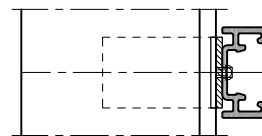

ST-095-01  
ST-0440

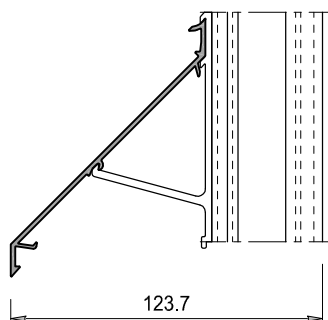
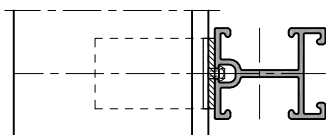

ST-095-01  
ST-0460

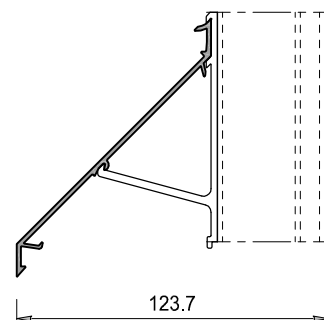
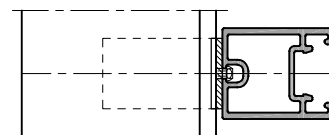

ST-095-01  
ST-0995

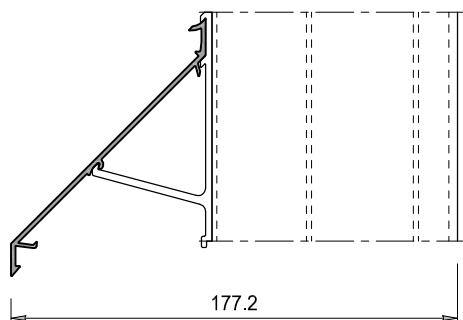
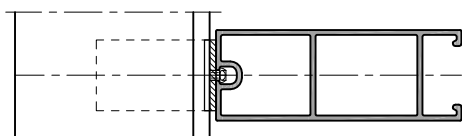

ST-095-01  
ST-1250

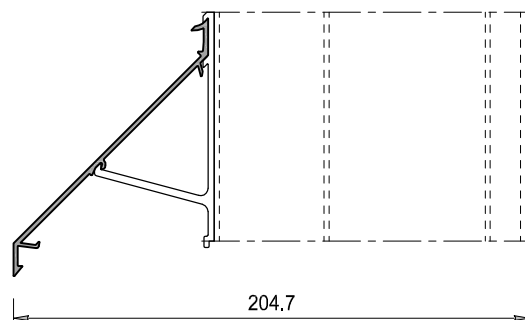
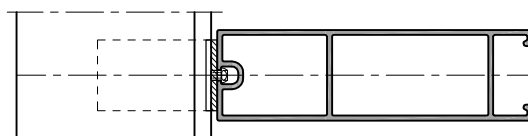

**STORAX**

Storax BV  
Wattstraat 1  
3335 LV Zwijndrecht  
Nederland

Tel. : +31 (0)78 303 09 00  
Fax : +31 (0)78 610 04 95  
E-mail: storax@storax.nl  
Website: www.storax.nl

Productgroep: Lamellenwand

Onderdeel : Lamel op dragerprofiel

Materiaal : Aluminium

Schaal: 1:3

Datum: 01-06-2016

Blad:

**095-01 DR**

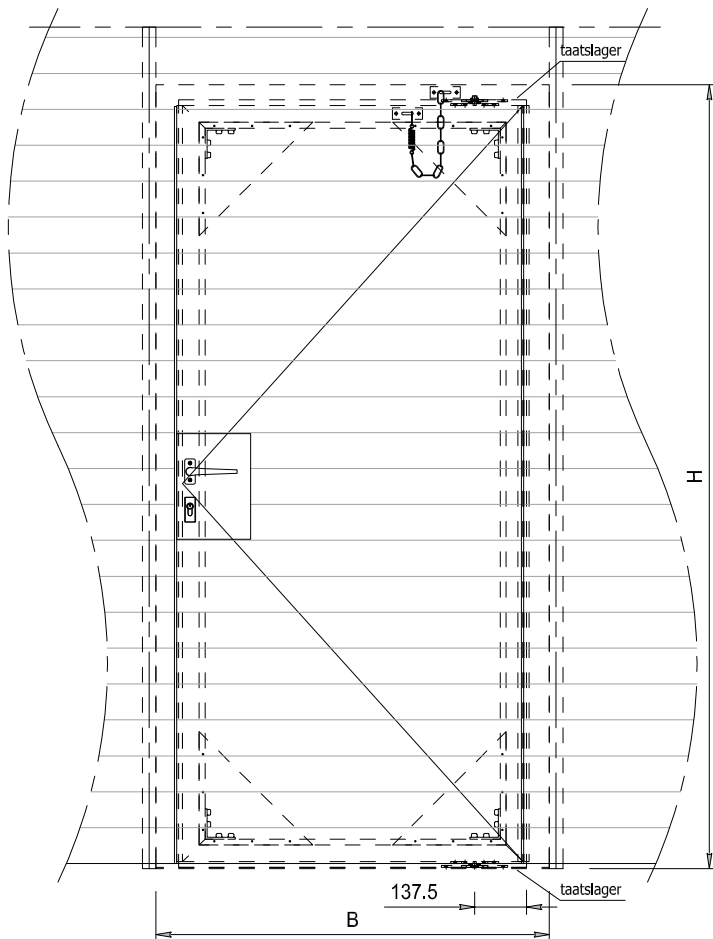

Legenda  
H ; Hoogte totaal in mm  
B ; Breedte totaal in mm  
X1; Hoogte deurvleugel in mm  
X2; Nuttige opening hoogte in mm  
S ; Stap / Steek in mm  
n ; aantal lamellen op de deur

(B=1500 mm maximaal)  
(H=2700 mm maximaal)

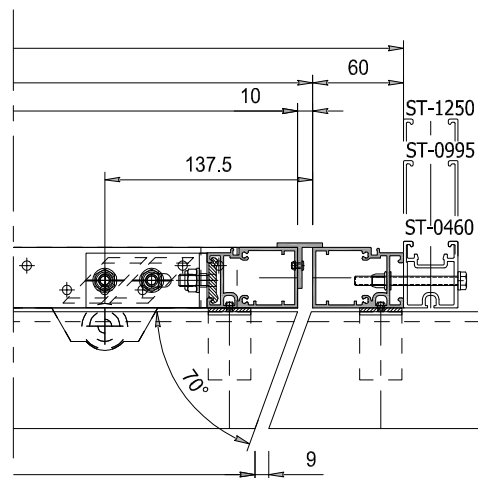
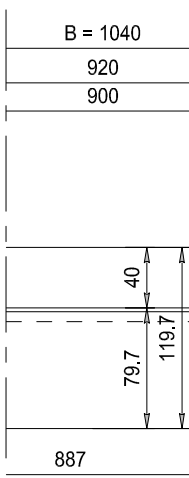
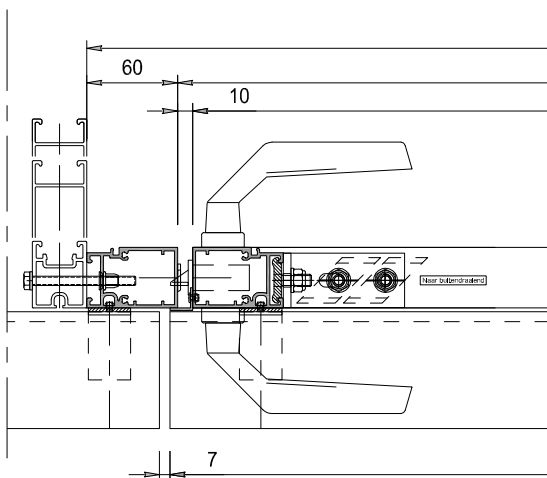
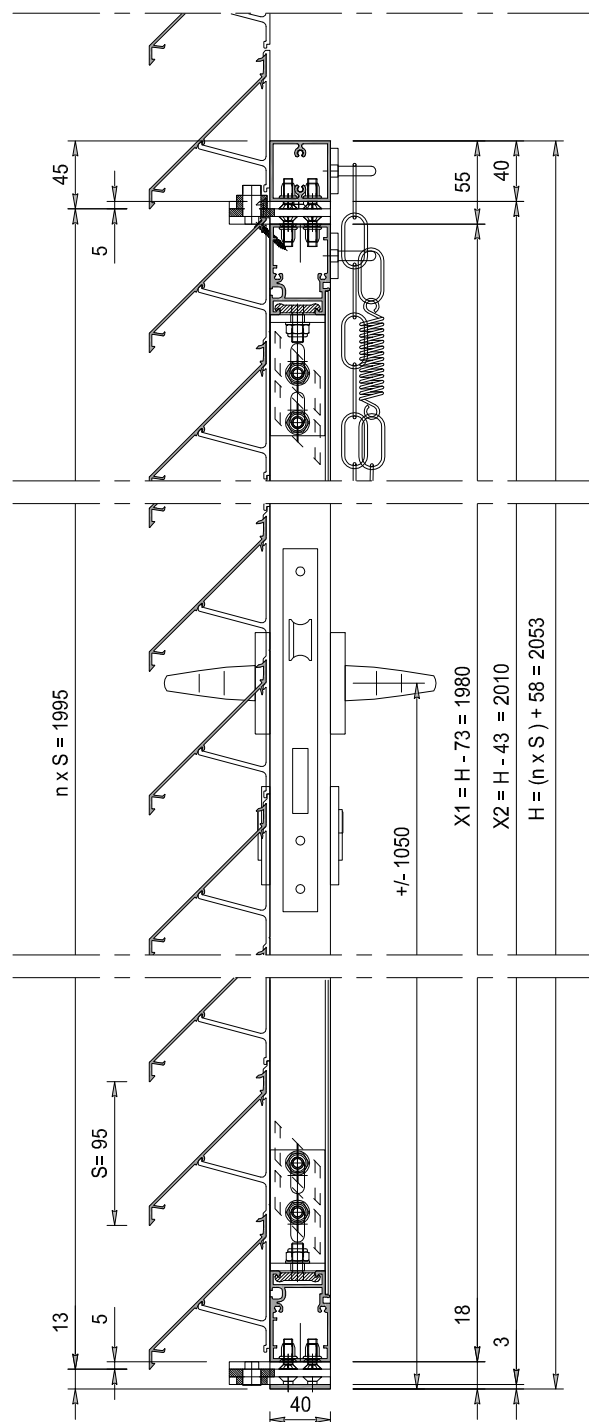

**STORAX**

Storax BV  
Wattstraat 1  
3335 LV Zwijndrecht  
Nederland

Tel. : +31 (0)78 303 09 00  
Fax : +31 (0)78 610 04 95  
E-mail: storax@storax.nl  
Website: www.storax.nl

Productgroep: Lamellenwand

Onderdeel : Deur met lamel ST-095-01

Materiaal : Aluminium

Schaal: 1:20 1:5

Datum: 01-06-2016

Blad:

**D-095-01**

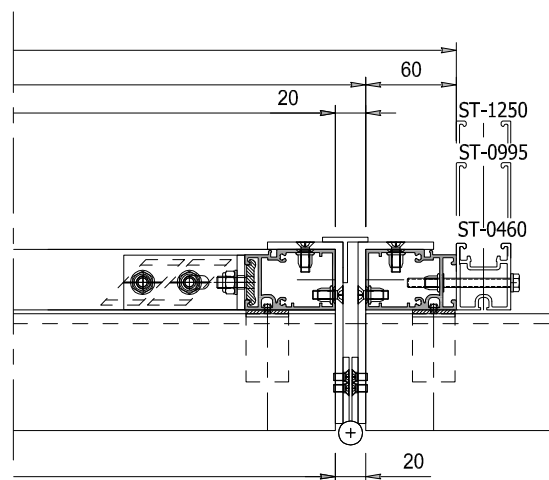
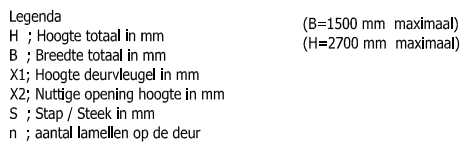

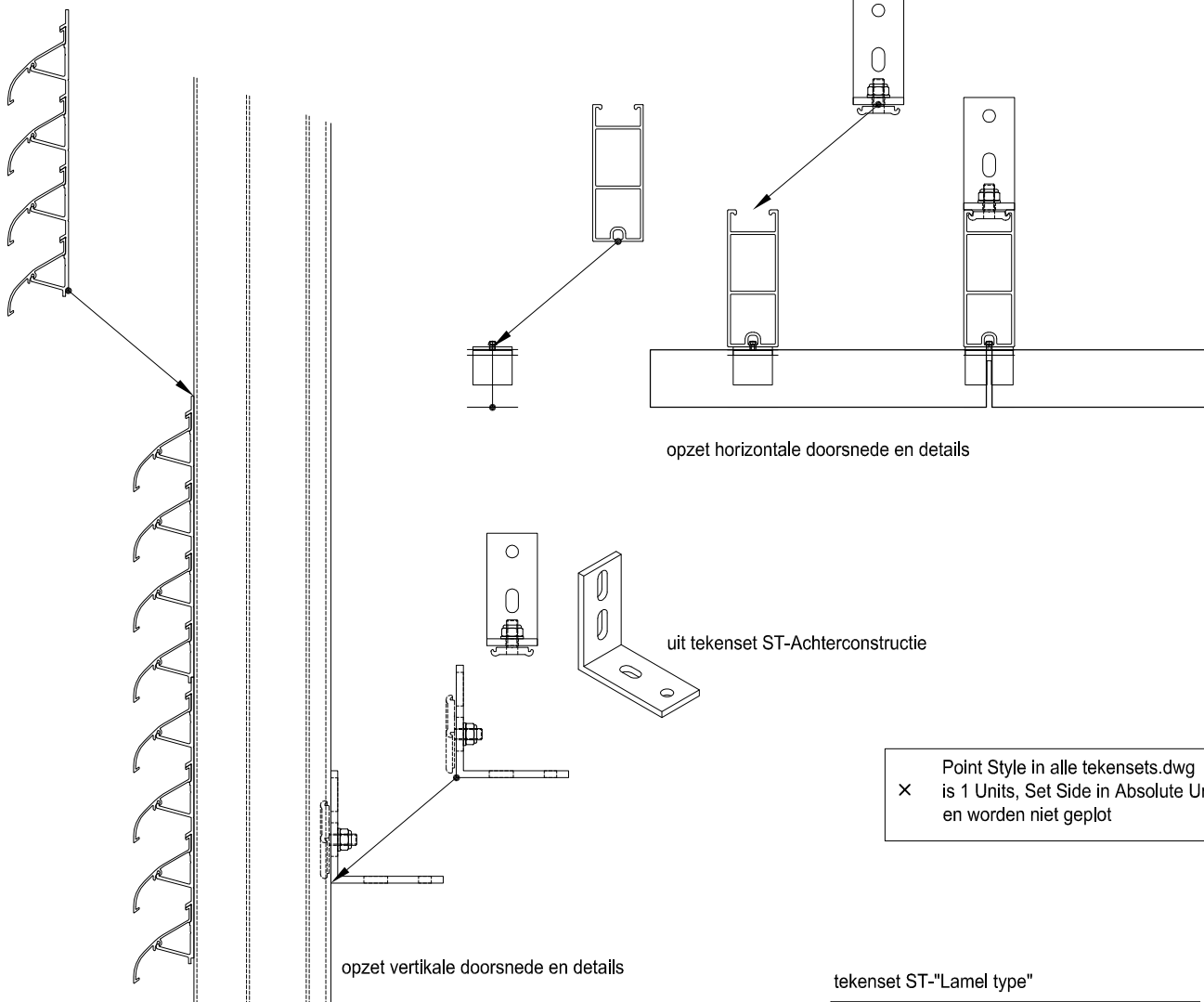

opzet horizontale doorsnede en details

uit tekenset ST-Achterconstructie

opzet verticale doorsnede en details

× Point Style in alle tekensets.dwg  
is 1 Units, Set Side in Absolute Units  
en worden niet geplot

Zie ook;  
Overzicht lamellen, zie tekening 01 en 02  
Overzicht dragers, deur en cassettekaders tek.03  
Overzicht bevestigings onderdelen, zie tekening 04  
Deuren in lamellenwand, zie tekening 05 t/m 11  
Cassettesysteem details, zie tekening 12

tekenset ST-"Lamel type"

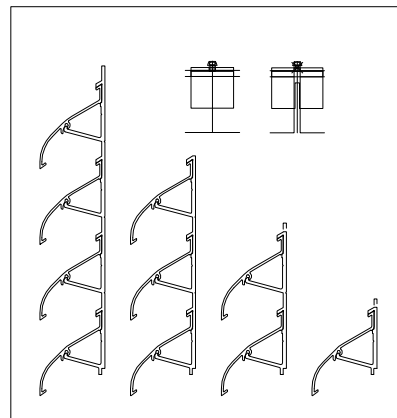

tekenset ST-DRAAGPROFIEL

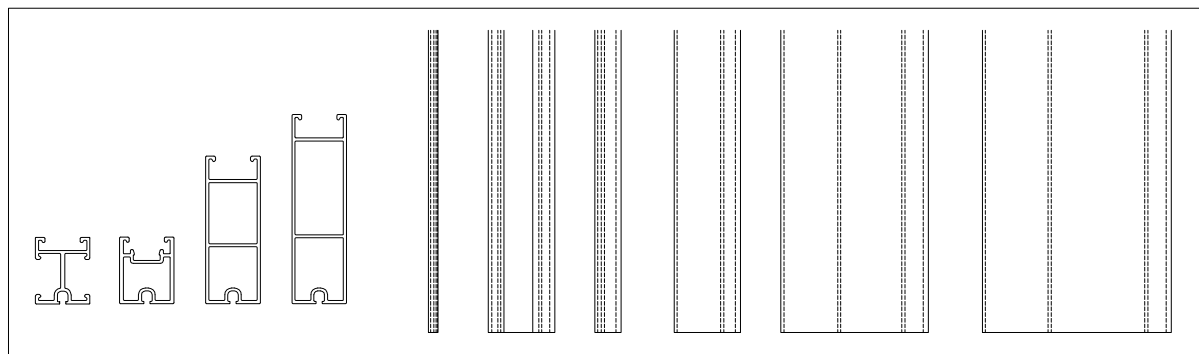

tekensets zijn in DWG formaat te downloaden



Storax BV  
Wattstraat 1  
3335 LV Zwijndrecht  
Nederland

Tel. : +31 (0)78 303 09 00  
Fax : +31 (0)78 610 04 95  
E-mail: storax@storax.nl  
Website: www.storax.nl

Productgroep: Lamellenwand

Onderdeel : Instructie gebruik tekensets in dwg

Materiaal : -

Schaal: -

Datum: 01-06-2016

Blad:

Instructie